

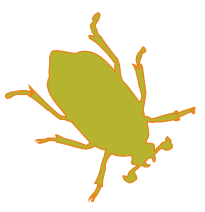

SUMMER CAMPS at the MILWAUKEE PUBLIC MUSEUM 2014



SUMMER CAMPS AT THE MILWAUKEE PUBLIC MUSEUM

Why does the Ptarmigan have feathers on its feet?

What culture uses tree bark for clothing?

Explore the wonders of our world – and beyond – during MPM’s fun and fascinating Summer Camps.

Ages 3-5

Fourteen single-day camps available between June 25 – August 14

Cost per camp session: \$35 non-members, \$25 members

When: 9:30-11:00 a.m. Wednesdays and Thursdays

Campers Ages 3-5 will:

- experience age appropriate exhibit discussions
- engage in hands-on activities using all senses
- use literature and song to explore camp topics



Ages 6-8 and 9-11

6 – 8: Six two-day camp sessions available between June 18 – August 7

9 – 11: One special two-day camp available July 9 & 10

Cost per camp session: \$115 non-members, \$90 members

When: 9:30 a.m. – 3:30 p.m. Wednesdays and Thursdays. Before- and after-care available!

Campers Ages 6-11 will:

- learn about their camp topic in museum exhibits
- engage in hands-on activities and handle real artifacts
- enjoy a giant screen movie or planetarium show



REGISTER OR LEARN MORE: (414) 278-2714



CAMP SESSIONS

AGES 3 - 5

Cost: \$25 members, \$35 non-members for each camp. Fee covers both child and adult, and includes general museum admission for the entire day.

Time: 9:30-11:00 a.m. Wednesdays and Thursdays.

What to bring: Please bring a bag in which campers can carry home their completed projects.

Who can come: Parents or adult chaperones are welcome, but not required, to join their child for these sessions at no additional cost. Unregistered children are not allowed to attend, including siblings and infants.

Camps feature age-appropriate learning experiences, and campers will learn about their subject through touch, sight and sound. We will handle artifacts and objects, make comparisons, learn about the environment and explore many cultures. Literature, music, art and observation will make each camp experience about exploration, discovery and fun! Camps begin with the familiar and branch into new experiences.

NOTE: Camps that are listed as ages 4-5 are structured for older children. No exceptions. Children age 3 are welcome to attend any of the camps specifically marked age 3 or ages 3-5.

AGE 3

June 25

Deadline: June 4

Animals of Africa

The animals of Africa are all so different! We will take a closer look at the lion, elephant, rhino, zebra, kudu and more as we travel through our Africa exhibit in search of similarities and differences. We will compare horns, furs, hides, body shapes and habitats. We will also experience the interactive story of Zomo the Rabbit, a tale from West Africa!

July 9

Deadline: June 18

Walking with Dinosaurs

The young dinosaur enthusiast will be thrilled to hold real dinosaur fossils in their hands! We will examine the Museum's collection of prehistoric creatures and will compare meat eaters and plant eaters and learn how each survived.

July 30

Deadline: July 9

Frog Mania

Did you know there are over 50 frogs in our Rain Forest exhibit? Frogs come in all shapes and sizes and live all over the world. We will go on a frog hunt and learn about these fun creatures through activities, observations and stories. Join us for some ribbeting discovery and fun!

AGES 3-5

July 16

Deadline: June 25

World of Butterflies

There is nothing quite like the elegance of a flying butterfly! We will learn all about this beautiful insect through stories, an interactive metamorphosis activity, and projects. Of course the day wouldn't be complete without a visit to our Butterfly Vivarium where dozens of live butterflies will help us celebrate all we've learned.

July 23

Deadline: July 2

Animal Habitats

Why don't we have scorpions in Wisconsin? Why does the Ptarmigan have feathers on its feet? We will take a look at different environments and the habitats that insects and animals thrive in. We will examine animal adaptations and survival skills of several kinds and learn some new science facts along the way!

August 6

Deadline: July 16

Oceans and Islands

During this camp, we will trek through the third floor exhibits learning about ocean animals, how the ocean changes as it gets deeper and then look at life on the Pacific Islands. Next we'll create crafts in the exhibits as we are surrounded by the sights and sounds of this tropical region.

August 13

Deadline: July 23

Dinosaur Discovery

The young dinosaur enthusiast will be thrilled to hold real dinosaur fossils in their hands while we examine the Museum's prehistoric collection. We will compare meat eaters and plant eaters, learn about the strengths of each type of dinosaur, and discuss how they become extinct.

CAMP SESSIONS

AGES 4-5

June 26

Deadline: June 5

African Safari

We will go on an African Safari to explore the amazing animals of this region. From the large African elephant to the weaver birds of the watering hole, these animals are all so different yet often depend on one another for survival. How do they protect themselves from their predators? What do they eat? These are just a few of the questions we will answer as we travel this diverse land.

July 10

Deadline: June 19

Dinosaurs over Time

We will explore the Triassic, Jurassic, and Cretaceous periods and take a walk through our Third Planet exhibit. From the earliest signs of life, to the presence of the fierce T-rex and the great extinction, we'll observe a geological timeline. Find out when your favorite dinosaur lived!

July 17

Deadline: June 26

Streets of Old Milwaukee

Travel back in time with us as we go back to the early 1900s! What was Milwaukee like? Who lived here and what did they do for work and play? We will stroll the streets and learn about jobs and activities, as well as the typical day of a young child. We might even get to see a silent movie in the nickelodeon theater!

July 24

Deadline: July 3

Native Americans: Living with the Land

In this camp, we will look at four North American regions and the natural resources each area provided for native people. We will travel to the wooded mountains of the Northwest Coast, the dry deserts of the Southwest, the grassy Plains and the Wisconsin Woodlands to see what we can find to build our homes, feed our families, make our clothes and pass the time!

July 31

Deadline: July 10

Life of a Tree Frog

Camp out in the Rain Forest exhibit as we explore the life of the Tree Frog. Through stories and activities we will learn all about these tiny creatures and the places they call home.

August 7

Deadline: July 17

Cultural Coat Closet

The Museum features many cultures from around the globe. In this camp we will learn about some different cultural traditions by comparing and learning about clothing. What areas of the world provided the best wool? Who used tree bark for clothing? We will hold and feel different fabrics and then create our own piece of clothing to wear home!

August 14

Deadline: July 24

Ooey, Gooley, Yuck!

Children learn best by having hands-on experiences, and that's what science is all about! We will examine some very interesting items from our Museum collection, learn what happens in some of our labs, then roll up our sleeves to concoct our own gooey experiments.



CAMP SESSIONS

AGES 6-8 and 9-11

Cost: \$90 members, \$115 non-members per each two-day camp. Campers must bring their own lunch.

Time: 9:30 a.m. – 3:30 p.m. Wednesdays and Thursdays. Before- and after-care available!

What to bring: Please provide your child's lunch each day in an insulated, labeled lunch bag.

Who can come: Camps for kids ages 6-8 and 9-11 are attended by the registered campers only. Chaperones or unregistered siblings or friends are not allowed to attend.

AGES 6-8

June 18 & 19

Deadline: May 28

Archaeology Expedition: Mummies!

All mummies come from Egypt, right? Well, not exactly. Many ancient people around the world mummified their dead and, in fact, people in South America were making mummies three thousand years before the Egyptians. Join us as we unwrap the secrets of mummies from many different lands, and find out why it was so important for ancient people.

June 25 & 26

Deadline: June 4

Rain Forest Adventures

Explore the world of rainforests from tropical to temperate through exhibits, artifacts and collections. This camp features amazing animals, remarkable trees that walk, myths and stories, and hands-on activities regarding rain forest biodiversity, foods, and resources.

July 16 & 17

Deadline: June 25

A World of Stories

Connect world cultures through stories, folktales, folklore, fairy tales, legends, myths, history, fantasy and facts. This camp features amazing animals, people and places from around the world. Campers will retell and create stories with a beginning, middle and end through hands-on activities, music, improvisation, games and art.

July 23 & 24

Deadline: July 2

Dinosaur Tales

Do dinosaurs tell stories? They do! And in this program we'll explore the stories of the dinosaurs through real fossils, museum exhibits, paleontologists' tools and hands-on activities that take you back 65 million years to when dinosaurs roamed the Earth. Learn about the unique characteristics of dinosaurs, their relationship to modern birds and reptiles, and take the Museum's legendary "Dinosaur Challenge."

MPM's summer campers get to experience the Museum in a very special way. Not only do they get a behind-the-scenes glimpse at the inner-workings of the Museum, but they get to explore the theme of their camp right in the Museum galleries. Campers even get to handle real artifacts!

Each camp will include ice-breakers, team building exercises, exhibit exploration and activities, especially in the areas that relate to the camp's theme. Lunch is scheduled around noon, followed by outside playtime (weather permitting).

July 30 & 31

Deadline: July 9

Geology Rocks!

Explore geology from fossils to stalactites and stalagmites. This camp features unique rocks encounters, rock art, rock identification, an exploration of museum exhibits, and the opportunity to curate your own rock collection!

August 6 & 7

Deadline: July 16

Games-Ancient to Modern

Before there were computers, television, cell phones and the internet, people played simple games of all kinds to pass the time, improve hunting skills and entertain themselves. Games of every description have been played for thousands of years, from ancient Persia and Middle America to the Streets of Old Milwaukee. In this camp we explore origins of—and play—some of the world's oldest games of chance, skill and amusement.

AGES 9-11

July 9 & 10

Deadline: June 18

Egyptian Mummies In-depth

Mission: Analyze a mummy to learn everything you can about him. When was he mummified? Where? How old was he at the time of mummification? What was his job in ancient Egypt, and how did he die? These are the questions mummy experts ask themselves, and this is what we'll try to discover as we examine two of the Museum's real ancient Egyptian mummies.

How Do I Register?

Step 1: Call Us

Registration must be completed three weeks prior to the desired camp's start date. Register by calling our admissions office at 414-278-2714. You will be mailed a confirmation of your registration.

Step 2: Complete the online Health Form

The health form must be submitted three weeks prior to the desired camp's start date. To begin, go to www.mpm.edu/user to set up a user account. After you have a user account, sign in and choose the tab labeled "camp forms." Next choose the option "Submit Health Form" and fill-in the appropriate information. Finally, select the "Submit Health Form" button, and you are finished!

Returning camper?

If your child attended camp last year, they are currently in our system and you simply need to update their old form with new information. To begin, go to www.mpm.edu/user to access your user account. Next choose the option "Completed Health Form," choose the form you'd like to resubmit and edit any information that has changed. Finally, select the "Submit Health Form" button, and you are finished!

No internet access?

Call (414) 278-2714 if you are unable to fill out the form online, and we will mail you a copy of the form to fill out and return. Registration deadline is three weeks prior to the first date of each session.



Camp Timelines

Ages 3 - 5

- 9 a.m. - check-in begins at check-in table
- 9:30 a.m. - camp begins in 3 - 5 Classroom
- 11 a.m. - pick-up time in 3 - 5 Classroom

Ages 6-8 and 9-11

- 8 a.m. - paid before-care begins
- 9:15 a.m. - regular check-in begins at check-in table
- 9:30 a.m. - camp begins in 6 - 11 Classroom
- 12 p.m. - lunch
- 12:30 p.m. - outdoor recess (weather permitting)
- 3:30 p.m. - pick-up begins in 6-11 check-out room
- 3:30 p.m. - paid after-care session begins
- 5 p.m. - after-care ends, Museum closes for the day

DROP-OFF AND PICK-UP PROCEDURES

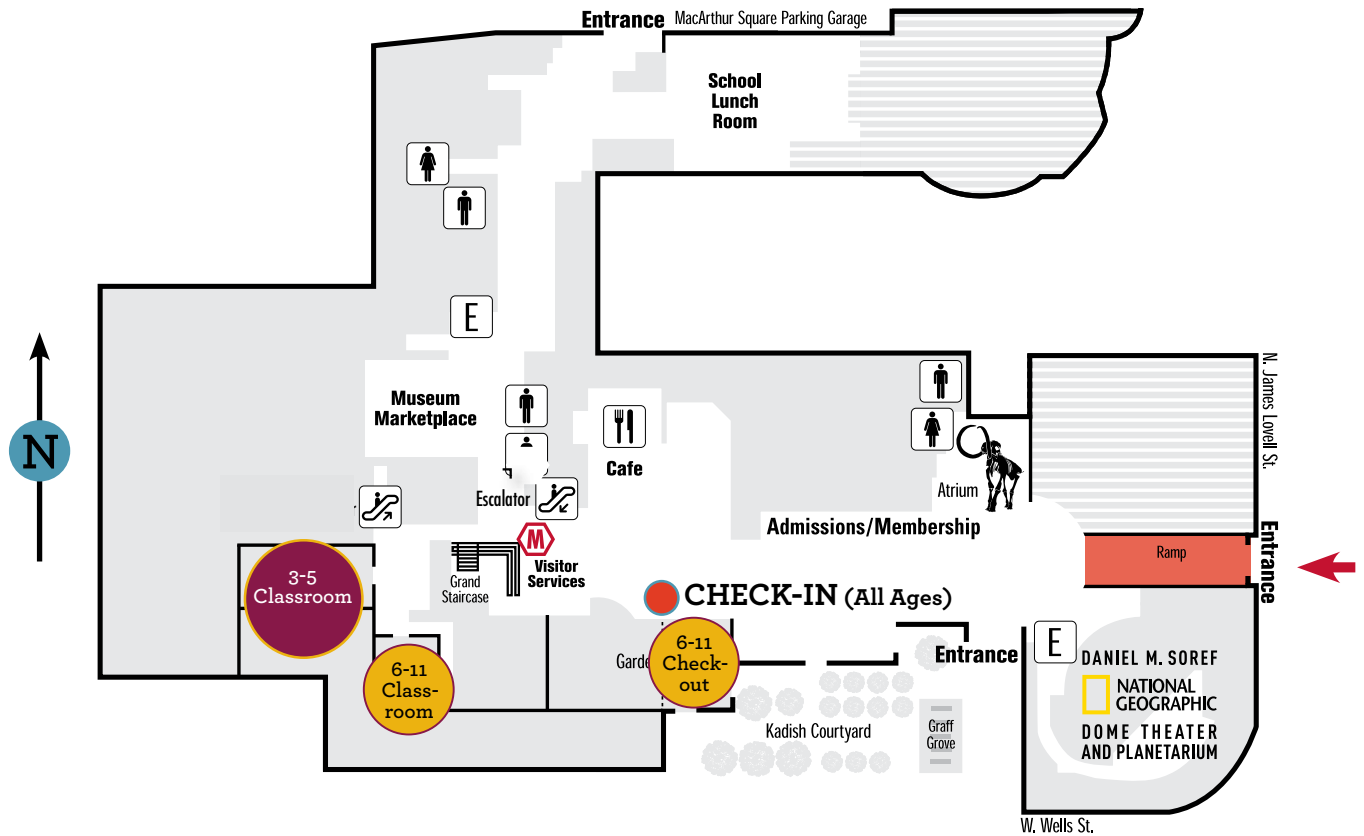

Ages 3 - 5

Where and when do I check in?

Please come to the check-in / check-out area near the MPM café (see map). Check-in begins at 9 a.m., but please be prepared to stay with your child until camp begins at 9:30 a.m. Activities will be provided during this time, and it is also an ideal time to tend to bathroom needs. If you are late, please check-in regardless so we can issue your wristbands and account for your arrival. At 9:30 a.m. the group will proceed to the Early Learning classroom. You may stay and participate at no additional cost, or leave and return. Unregistered children are not allowed to attend camp (this including siblings).

Where do I pick up my child(ren)?

Please come to the 3-5 classroom to pick up your child at 11 a.m. There is no early drop-off or late pick-up for the 3-5-year-old campers.

AGES 6-8 and 9-11

Where and when do I check in?

Please come to the check-in area near the MPM café (see map). Before-care check-in begins at 8 a.m., and regular check-in begins at 9:15 a.m. You must accompany your child into the building and check in with camp staff by 9:20 a.m. During check-in, we will need you to verify emergency contact information and any health or medical instructions.

Where do I pick up my child(ren)?

Please come to the check-in / check-out area (see map) to pick up your child at 3:30 p.m. Notify the camp teacher and sign the child out. Camp teachers will wait with children until 3:35 p.m. Those arriving late for pick-up will be charged \$5 (cash) per every 5 minutes they are late. Anyone picking up your child must present an ID and must be listed on your camp registration forms.

How do I sign up for before- and / or after-care?

Please sign up for before- and / or after-care when you register, and note your arrival and pick up times. The cost is \$20 for two days of before-care, and \$20 for two days of after-care. If you take advantage of before- and after-care on each day of a two-day camp, the total cost will be \$40.

CAMP FAQs

Do you offer refunds or exchanges?

Camp reservations are non-refundable and non-exchangeable, except in the following situations:

- If arrangements are made three weeks prior to your original program date, enrollment may be transferred to a new date and time if there is room in that program.
- If we cancel the camp due to low enrollment, you will receive a full refund.

What if more than one of my children is registering, or my child wants to attend with a friend?

Please submit one form per child. Friends or siblings who wish to attend camp together:

- must both fall within the age requirements of the session they plan to attend together.
- should both submit a separate form.

What is included with camp fees?

Drawstring bags are given to all two-day campers in the 6-8 and 9-11 age groups. If your child is signed up for multiple camps, he/she will receive one bag.

Who teaches the camps?

Our camp staff is comprised of museum educators who plan and deliver interactive learning that will interest campers of all ages.

What if my child requires medication?

The museum is not permitted to administer medication to any children at camp. Please make arrangements to administer medication during the day, such as at lunch time (around noon).

Can I bring my child early, or pick them up late?

Yes. Before and after-care sessions are available for campers ages 6-8 and 9-11.

Do you offer scholarships?

We do not offer camp scholarships, but members receive a discount on camp registration.

Do you provide snacks and lunch?

We provide a morning snack for campers ages 6-8 and 9-11. You must send your child with a lunch, in a labeled lunch bag. Campers ages 3-5 will not have snacks or lunch.

What are behavioral expectations?

To ensure an appropriate learning environment, MPM reserves the right, upon notification of parents, to dismiss any student during any session for conduct that camp administrative staff deems detrimental to the well-being of other students, staff, or to the overall operation of the camp.

Can I become an MPM member to receive a discount when I register?

Yes! Members receive a \$25 member discount on two-day camps for ages 6-8 and 9-11 or a \$10 discount on camps for ages 3-5.

Contacts

For specific, non-registration questions contact:

- Ages 3-5: Early Childhood Coordinator at (414) 278-6943
- Ages 6-8 and 9-11: Public Programs Coordinator (414) 278-2715 or summercamps@mpm.edu

6-8

June 18 & 19
Archaeology Expedition: Mummies!
Registration deadline: May 28

6-8

June 25 & 26
Rainforest Adventures
Registration deadline: June 4

3

June 25
Animals of Africa
Registration deadline: June 4

4-5

June 26
African Safari
Registration deadline: June 5

9-11

July 9 & 10
Egyptian Mummies In-depth
Registration deadline: June 18

3

July 9
Walking with Dinosaurs
Registration deadline: June 18

4-5

July 10
Dinosaurs over Time
Registration deadline: June 19

6-8

July 16 & 17
A World of Stories
Registration deadline: June 25

3-5

July 16
World of Butterflies
Registration deadline: June 25

4-5

July 17
Streets of Old Milwaukee
Registration deadline: June 26

6-8

July 23 & 24
Dinosaur Tales
Registration deadline: July 2

3-5

July 23
Animal Habitats
Registration deadline: July 2

4-5

July 24
Native Americans: Living with the Land
Registration deadline: July 3

6-8

July 30 & 31
Geology Rocks!
Registration deadline: July 9

3

July 30
Frog Mania
Registration deadline: July 9

4-5

July 31
Life of a Tree Frog
Registration deadline: July 10

6-8

August 6 & 7
Games
Registration deadline: July 16

3-5

August 6
Oceans and Islands
Registration deadline: July 16

4-5

August 7
Cultural Coat Closet
Registration deadline: July 17

3-5

August 13
Dinosaur Discovery
Registration deadline: July 23

4-5

August 14
Ooey, Gooey, Yuck!
Registration deadline July 24